

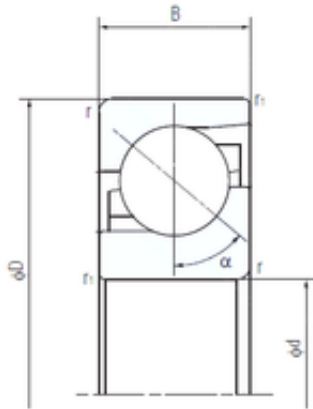

**50 mm x 110 mm x 27 mm NACHI 50TAF11  
thrust ball bearings**



Bearing No. 50TAF11

Size	50x110x27 mm
Bore Diameter	50 mm
Outer Diameter	110 mm
Width	27 mm
d	50 mm
D	110 mm
B	27 mm
C	27 mm
Angle ( )	50 °
r min.	2 mm
r1 min.	1 mm
Weight	1,13 Kg
Basic dynamic load rating (C)	152 kN
Basic static load rating (C0)	118 kN

50TAF11 Bearing 2D drawings and 3D CAD models